

HOW TO REPLACE YOUR SECURITY SYSTEM'S CELLULAR MODULE

Security Professional Phone Number:

Security Professional Email Address:

Monitoring Station Phone Number:

Installation Date and Time:



Before You Get Started

Please read these instructions carefully and completely. This process is also available in video format on YouTube at: <https://www.youtube.com/watch?v=92jjmlzBbPo>

Or use your cell phone's camera to scan the QR code to the right quickly access the video.

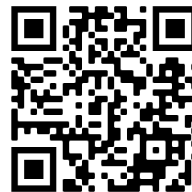

Tools You Will Need

- Phillips head screwdriver

HOW TO REPLACE YOUR SECURITY SYSTEM'S CELLULAR MODULE

Let's jump right in...

STEP 1:

Call your Security Dealer at the phone number at the top of these instructions during business hours. Inform them that you are about to perform a cellular module upgrade. It is important that this process is completed during your Security Professional's business hours as you will need them to finalize the installation.

STEP 2:

Call your Monitoring Station and ask them to **"Put my alarm system on test"** as you are about to perform a cellular module upgrade. **The Monitoring Station may ask for your passcode to verify your identity.**

STEP 3:

Locate the **main alarm panel** installed in your home or business. Proceed with the following steps:

STEP 4:

Press the **"Security"** icon on the touchscreen.

Press **"Tools"**.

Enter your 4-digit alarm code.

Press **"Advanced"**.

Press **"Install Cellular Module"**.

Press **"Yes"**.

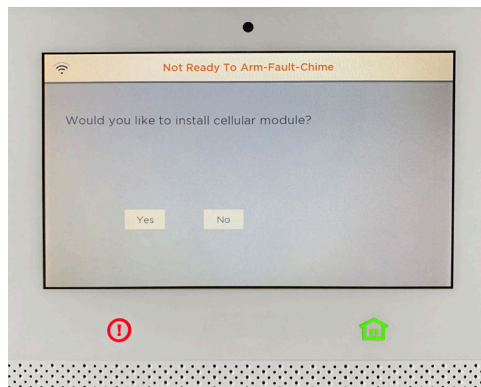

HOW TO REPLACE YOUR SECURITY SYSTEM'S CELLULAR MODULE

STEP 5:

Complete the following steps:

Remove the panel side cover (on the rights side) by pushing it upward.



STEP 6:

Remove the existing cellular module by removing the Philips screw (if present);

And pulling on the blue tab.



STEP 7:

Open the new cellular module box that was sent to you and unpack the contents.

The box will include:

- Cellular module
- Mounting screws

STEP 8:

Install the new cellular module by pushing it in until flush and then secure with the screw provided.

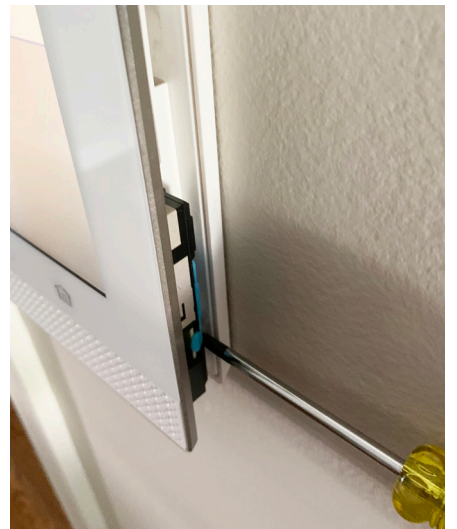

HOW TO REPLACE YOUR SECURITY SYSTEM'S CELLULAR MODULE

STEP 9:

Reinstall the panel side cover and slide it downward to lock.

STEP 10:

Click **"OK"** on the touchscreen.

STEP 11:

Wait fifteen (15) minutes and then call your Security Professional at the number listed at the top of these instructions to complete the installation. If you experience any irregularities, please call your Security Professional.

When speaking with your Security Professional, they may need the new AID and CRC located on the cellular module label. Having this information readily available will expedite the process.

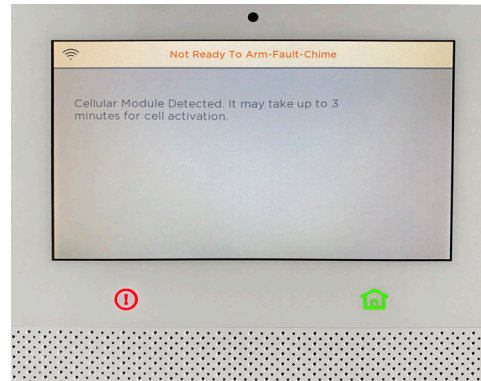

STEP 12:

If your dealer and central station are different, please call your Monitoring Station and ask them to **"Take my alarm system off test."**

Replacement Completed – Fantastic job!

Thank you for completing your cellular module upgrade.

Learn more at www.resideo.com