

Installation and Setup Guide

The PROSIXLCDKP-EU is a wireless keypad for use with Control Panels that support SiX™ series devices. Up to eight (8) Keypads can be used on the system.

Note: Installation shall be done in accordance with local regulations.

Item/Key	Function
Display Window	Liquid Crystal Display (LCD) displays protection point identification, system status, and messages.
	Power LED
	System Status LED
	System Trouble LED
AWAY	Arm Away key
HOME	Arm Home (Stay) key
NIGHT	Arm Night (Stay) key
1 OFF	OFF key
2 SELECT	Select key
3 SCROLL	<ul style="list-style-type: none"> Scroll key Local Programming key (2-second hold)
4 MAX	Arm Maximum key (No Delay)
5 TEST	System Test key
6 BYPASS	Bypass Zone key
7 INSTANT	Arm Instant key (No Delay)
8 CODE	Add Security Codes key
9 CHIME	Chime Mode key
* READY	Check Zones key
0 #	Quick Arm key
	Disarm/Cancel Key
	Panic Alarm key
	Fire Panic key
	Police Panic key
	Medical Panic key
Keys 0 - 9	Numeric keys used to enter security code(s).
	Prox Tag reader (RFID)

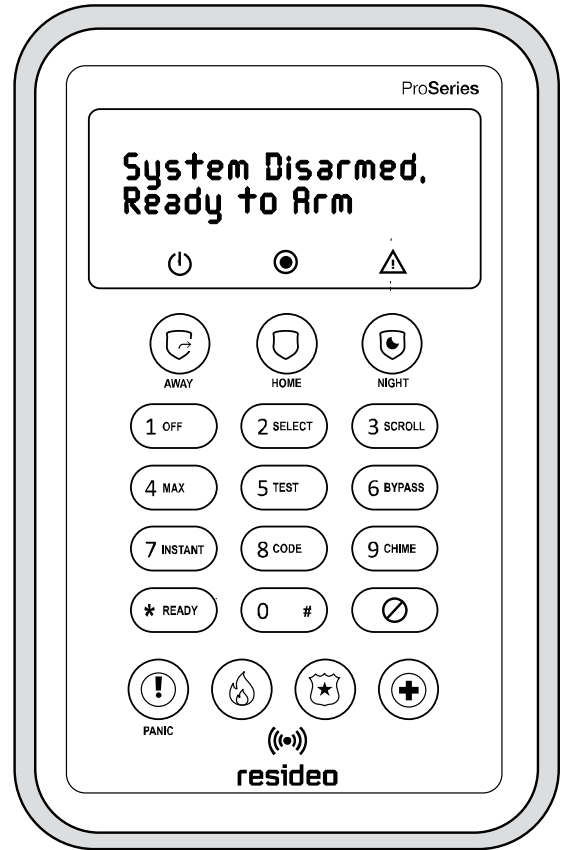

QSEU-002-V2

KEYPAD OPERATION

For operating instructions, refer to the Control Panel instructions.

LEDs	Off	Red - Steady	Green - Steady	Red - Flashing
POWER			Battery - OK	Battery - Low
STATUS	Not Ready to Arm	Armed	Ready to Arm	Alarm Detected
TROUBLE	No Trouble Present	System Trouble Present	--	Device Trouble Present

Note: When the system is in Programming Mode, the Trouble and Status LEDs alternately flash Red and Green.

KEYPAD MOUNTING

The keypads can be surface mounted directly to a wall as follows:

1. Separate the keypad front panel [A] to the rear mounting plate [B].
2. Mount the mounting plate to the wall using the screws [C]. Insert the tamper screw [D] as shown.
Note: Mounting screws not provided. Use 3.5mm – 4mm wood screws (with plastic wall anchors, if necessary).
3. Pull out the battery activation tab [E] from the back of the keypad front panel.
4. Align the case with the cleats [F] and snap into place and secure with bottom screw [G] (provided).

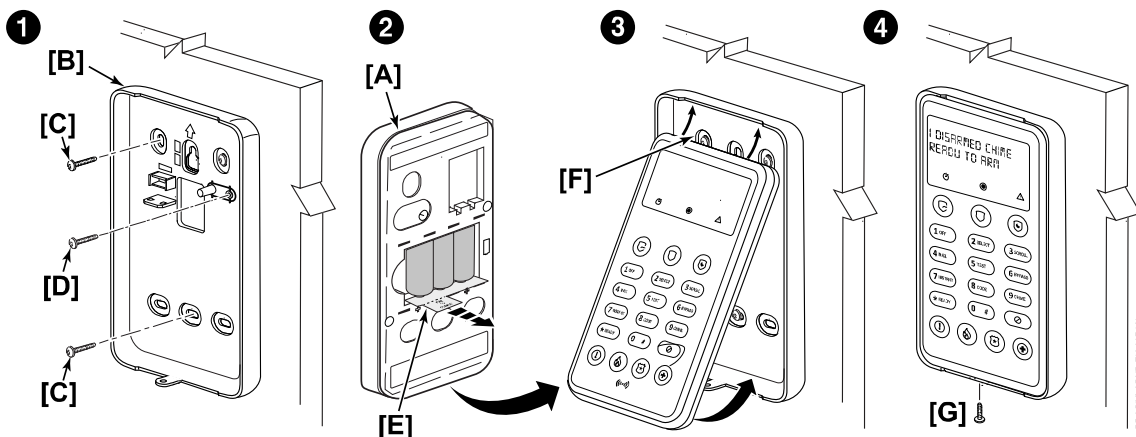

AUTHENTICATING KEYPAD USER

For security purposes, a user (or installer) of the keypad must be authenticated prior to being able to access/view any of the keypad displays. To authenticate a user, perform the following steps.

Note: Nothing will be displayed, even if the system is armed, until a valid PIN (or Prox Tag) is entered.

1. At the keypad, enter the PIN (or swipe the Prox Tag) for the user.
2. After a successful authentication, enter the command starting with "1" = arm if the panel is DISARMED or "5" if the panel is ARMED.

ENROLLING KEYPAD

The keypad must be enrolled in the Control Panel before it can be used. Registration and programming are conducted through the AlarmNet 360™ cloud-based management platform, using the Resideo Pro App. After accessing the customer account, perform the following steps.

1. From the Select "KEYPADS".
2. Select "ADD KEYPAD".
3. Select "Learn" and wait for the Control Panel to be in learning mode.
4. Activate the keypad by pressing any key:
 - The keypad automatically attempts to pair with the Control Panel. The top three status LEDs [A] and bottom four Panic keys [B] will come on (red).
 - If enrollment is not successful, press any of the keys on the keypad to restart the pairing process or remove and reinstall batteries.
5. After a successful pairing:
 - The keypad displays "Paired with System", then displays "Waiting for Status Update" until exit of the program mode.
 - The top three status LEDs and bottom four Panic keys will go off and two beeps will sound to confirm the pairing.
 - The system then displays system status.
6. After enrollment, program and save the keypad's zone options (zone descriptor, etc.)

Note: Make sure to assign a descriptor to the keypad for easy identification when keypad events occur.

IMPORTANT: After enrolled, the keypad cannot be used with another Control Panel until it is un-enrolled (deleted) from the current panel through the AlarmNet 360™ cloud-based management platform.

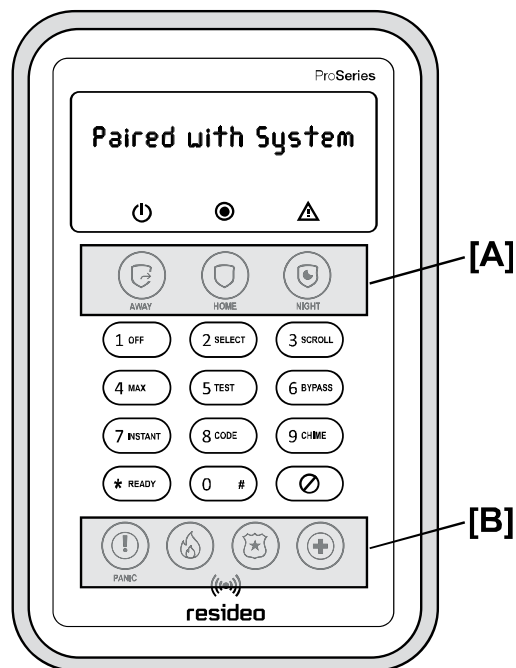

PROSMLCOP-EU-005-A-V0

BATTERY REPLACEMENT

1. At the bottom of the keypad, remove the screw that secures the front cover to the rear mounting bracket.
2. Remove the batteries, wait 10 seconds, then insert three new 3V Lithium batteries (see **Specifications** for replacement batteries).
3. Align the case with the cleats and snap into place and secure with bottom screw

BATTERY CAUTION: Risk of fire, explosion, and burns. Do not recharge, disassemble, heat above 55°C, or incinerate. Dispose of used batteries properly. Keep away from children.

Note: Constant exposure to high or low temperature or high humidity may reduce battery life.

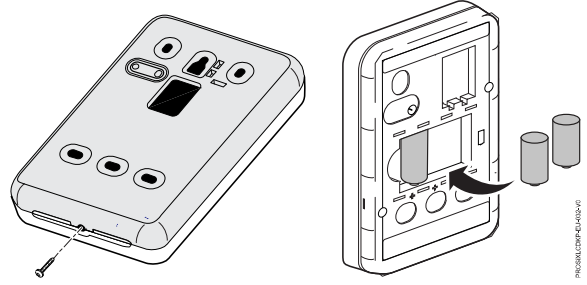

PANIC KEYS

This keypad also features panic keys. These keys may be programmed for Fire, Police, and Medical alarms. Panic activation requires a 2-button sequence. After the first button in the sequence is pressed, you can cancel the panic by pressing any key other than one of the panic keys.



Panic



Fire



Police



Medical

There are 3 ways to generate an alarm:

1. Press **Panic** and within 10 seconds press the desired panic key (**Fire, Police, Medical**).
2. Press desired panic key and within 10 seconds press the **Panic** button.
3. Press desired panic key and within 10 seconds press the same key.

KEYPAD PROGRAMMING MODE

This mode displays keypad programmed information and provides access to Default and Reset options. Enter the INSTALLER code +1 to disarm. Press and hold the "3" key for 2 seconds to enter PROGRAMMING mode. The system will exit PROGRAMMING mode after 1 minute of inactivity. Press the "3" key to scroll or "*" key to exit.

Display	Meaning/Option	Display	Meaning/Option
App: / Boot:	Displays the keypad's current App and Boot versions	Partition= / Keypad ID=	Displays Partition assignment and Keypad ID programmed in the control panel.
RF6:	Displays the keypad's SiX software version and the keypad MAC ID	Reset Keypad	Prompts to Reset Keypad. 2=CONFIRM (restart)
Default Keypad	Prompts to Default Keypad. 2 = CONFIRM to remove keypad from control panel. Note: If the keypad is repowered within 24 hours, it will re-pair with the control panel. After 24 hours, it will need to be re-enrolled.	A: None	(Future Use)
		B: None	(Future Use)

SPECIFICATIONS:

Dimensions (mm) / Weight: 161 (H) x 97 (W) x 34 (D) / 285 g
Frequency of Operation: 2.4 GHz

Batteries: Three (3) - 3V Lithium batteries, Panasonic CR123A/Duracell DL123A
Tamper: Wall (audible alert and signal sent to Control Panel)
Sounder: Piezoelectric



(XXXX-XXXXXX)

www.cnpp.com
www.marque-nf.com



The product should not be disposed of with other household waste. Check for the nearest authorized collection centers or authorized recyclers. The correct disposal of end-of-life equipment will help prevent potential negative consequences for the environment and human health.

This system must be checked by a qualified technician at least once every three (3) years.

Any attempt to reverse-engineer this device by decoding proprietary protocols, de-compiling firmware, or any similar actions is strictly prohibited.

REFER TO THE INSTALLATION INSTRUCTIONS FOR THE CONTROL WITH WHICH THIS DEVICE IS USED, FOR DETAILS REGARDING LIMITATIONS OF THE ENTIRE ALARM SYSTEM.

SUPPORT & WARRANTY INFORMATION

For the latest documentation, warranty, and support, please go to: www.resideo.com



Sécurité Communications SAS (SECOM)
1198, Avenue du Docteur Maurice Donat
06250 Mougins - FRANCE



Ademco 1 Ltd., 200 Berkshire Place
Winnersh Triangle, Berkshire,
RG41 5RD – UNITED KINGDOM

PROSIXLCDKP-EU



R800-26496B 01/21 Rev B

resideo

© 2022 Resideo Technologies, Inc.
www.resideo.com