

Installation and Setup Guide

The PROSIXLEDKP-EU is a wireless keypad for use with Control Panels that support SiX™ series devices. Up to eight (8) Keypads can be used on the system.

Note: Installation shall be done in accordance with local regulations.

Item	Function
Speaker	Sounds status tones
	Power LED
	System Status LED
	System Trouble LED
AWAY	Arm Away key
HOME	Arm Home (Stay) key
NIGHT	Arm Night (Stay) key
1 OFF	OFF key
2 SELECT	Select key
3 SCROLL	<ul style="list-style-type: none"> Scroll key Local Programming key (2-second hold)
4 MAX	Arm Maximum key (No Delay)
5 TEST	System Test key
6 BYPASS	Bypass Zone key
7 INSTANT	Arm Instant key (No Delay)
8 CODE	Add Security Codes key
9 CHIME	Chime Mode key
* READY	Check Zones key
0 #	Quick Arm key
	Disarm/Cancel Key
	Panic Alarm key
	Fire Panic key
	Police Panic key
	Medical Panic key
Keys 0 - 9	Numeric keys used to enter security code(s).
	Prox Tag reader (RFID)

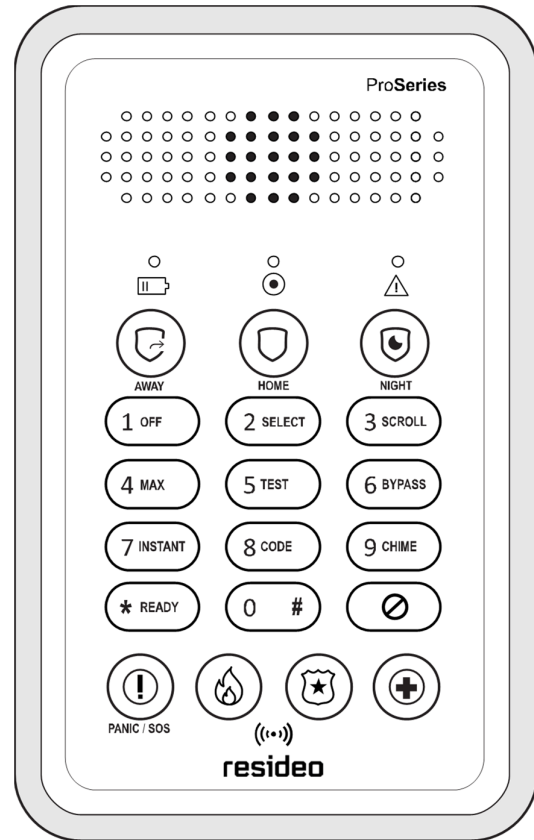

PROSIXLEDKP-EU-004-V0

KEYPAD OPERATION

For operating instructions, refer to the Control Panel instructions.

LEDs	Off	Red	Green	Flashing Red
POWER			Battery - OK	Battery - Low
STATUS	Not Ready to Arm	Armed	Ready to Arm	Alarm/Alarm Memory
TROUBLE		System Trouble	--	Device Trouble

KEYPAD MOUNTING

The keypads can be surface mounted directly to a wall as follows:

1. Separate the keypad front panel [A] to the rear mounting plate [B].
2. Mount the mounting plate to the wall using the screws [C]. Insert the tamper screw [D] as shown.
Note: Mounting screws not provided. Use 3.5mm – 4mm wood screws (with plastic wall anchors, if necessary).
3. Pull out the battery activation tab [E] from the back of the keypad front panel.
4. Align the case with the cleats [F] and snap into place and secure with bottom screw [G] (provided).

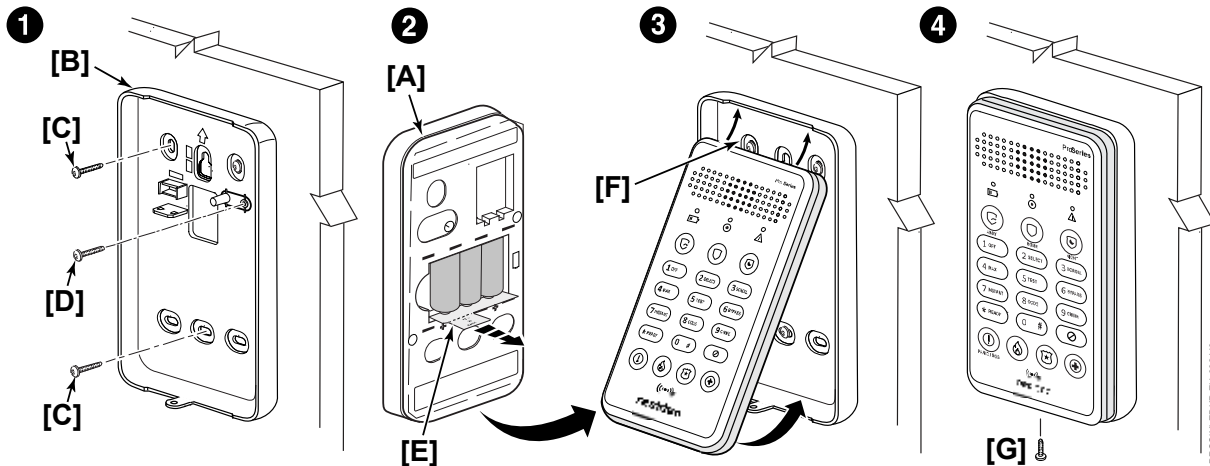

AUTHENTICATING KEYPAD USER

For security purposes, a user (or installer) of the keypad must be authenticated prior to being able to access/view any of the keypad status indicators. To authenticate a user, perform the following steps.

Note: No status indicators will be displayed, even if the system is armed, until a valid PIN (or Prox Tag) is entered.

1. At the keypad, enter the PIN (or swipe the Prox Tag) for the user.
2. After a successful authentication, enter the command starting with "1" = arm if the panel is DISARMED or "5" if the panel is ARMED.

ENROLLING KEYPAD

The keypad must be enrolled in the Control Panel before it can be used. Registration and programming are conducted through the AlarmNet 360™ cloud-based management platform, using the Resideo Pro App. After accessing the customer account, perform the following steps.

1. From the Select "KEYPADS".
2. Select "ADD KEYPAD".
3. Select "Learn" and wait for the Control Panel to be in learning mode.
4. Activate the keypad by pressing any key:
 - The keypad automatically attempts to pair with the Control Panel.
 - The top three status LEDs [A] and bottom four Panic keys [B] will come on (red).
 - If enrollment is not successful, press any of the keys on the keypad to restart the pairing process or disconnect and reconnect power.
5. After a successful pairing, the top three status LEDs and bottom four Panic keys will go off and two beeps will sound to confirm the pairing.
6. After enrollment, program and save the keypad's zone options (zone descriptor, etc.)

Note: Make sure to assign a descriptor to the keypad for easy identification when keypad events occur.

IMPORTANT: After enrolled, the keypad cannot be used with another Control Panel until it is un-enrolled (deleted) from the current panel through the AlarmNet 360™ cloud-based management platform.

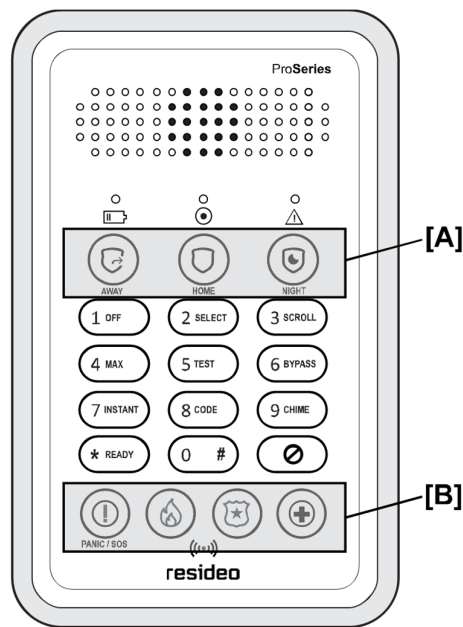

Note: For detailed programming instructions refer to the Installation Instructions for the Control Panel with which this device is used.

BATTERY REPLACEMENT

1. At the bottom of the keypad, remove the screw that secures the front cover to the rear mounting bracket.
2. Remove the batteries, wait 10 seconds, then insert three new 3V Lithium batteries (see **Specifications** for replacement batteries).
3. Align the case with the cleats and snap into place and secure with bottom screw

BATTERY CAUTION: Risk of fire, explosion, and burns. Do not recharge, disassemble, heat above 55°C, or incinerate. Dispose of used batteries properly. Keep away from children.

Note: Constant exposure to high or low temperature or high humidity may reduce battery life.

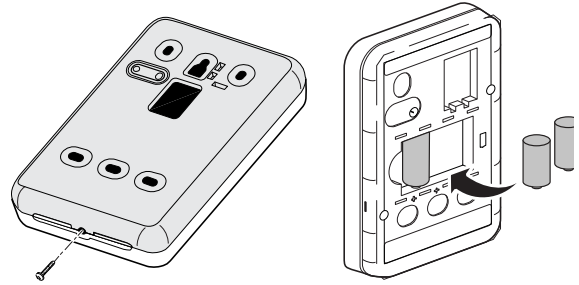

PANIC KEYS

This keypad also features panic keys. These keys may be programmed for Fire, Police, and Medical alarms. Panic activation requires a 2-button sequence. After the first button in the sequence is pressed, you can cancel the panic by pressing any key other than one of the panic keys.



Panic

Fire

Police

Medical

There are 3 ways to generate an alarm:

1. Press **Panic** and within 10 seconds press the desired panic key (**Fire, Police, Medical**).
2. Press desired panic key and within 10 seconds press the **Panic** button.
3. Press desired panic key and within 10 seconds press the same key.

SPECIFICATIONS:

Dimensions (mm) / Weight: 153 (H) x 98 (W) x 34 (D) / 283 g

Frequency of Operation: 2.4 GHz

Tamper: Wall (audible alert and signal sent to Control Panel)

Sounder: Piezoelectric

Batteries: Three (3) - 3V Lithium batteries

- EVE CR123A
- Panasonic CR123A
- Duracell DL123A



(XXXX-XXXXXX)

www.cnpp.com
www.marque-nf.com



The product should not be disposed of with other household waste. Check for the nearest authorized collection centers or authorized recyclers. The correct disposal of end-of-life equipment will help prevent potential negative consequences for the environment and human health.

This system must be checked by a qualified technician at least once every three (3) years.

Any attempt to reverse-engineer this device by decoding proprietary protocols, de-compiling firmware, or any similar actions is strictly prohibited.

REFER TO THE INSTALLATION INSTRUCTIONS FOR THE CONTROL WITH WHICH THIS DEVICE IS USED, FOR DETAILS REGARDING LIMITATIONS OF THE ENTIRE ALARM SYSTEM

SUPPORT & WARRANTY INFORMATION

For the latest documentation, warranty, and support, please go to: www.resideo.com



Sécurité Communications SAS (SECOM)
1198, Avenue du Docteur Maurice Donat
06250 Mougins - FRANCE



Ademco 1 Ltd., 200 Berkshire Place
Winnersh Triangle, Berkshire,
RG41 5RD – UNITED KINGDOM

PROSIXLEDKP-EU



R800-26885B 01/22 Rev B

resideo

© 2022 Resideo Technologies, Inc.
www.resideo.com